

[Positive Suction] [Constant Presumed Terminal Pressure Water Supply] [4-Pumps Parallel 5-Pumps Rotation]

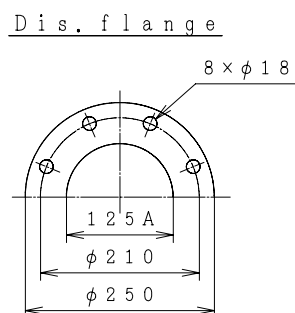

| No | Parts Name | Q'T |
|----|-----------------------------------|-----|
| 1 | Pump | 5 |
| 2 | Pressure tank (20ℓ) | 1 |
| 3 | Pressure transmitter | 1 |
| 4 | Flow switch | 5 |
| 5 | TJ valve | 1 |
| 6 | Protector | 5 |
| 7 | Check valve (with flow switch) | 5 |
| 8 | Stop valve | 5 |
| 9 | Control panel | 1 |
| 10 | Special flange (Suction) | 5 |
| 11 | Blind Flange | 1 |

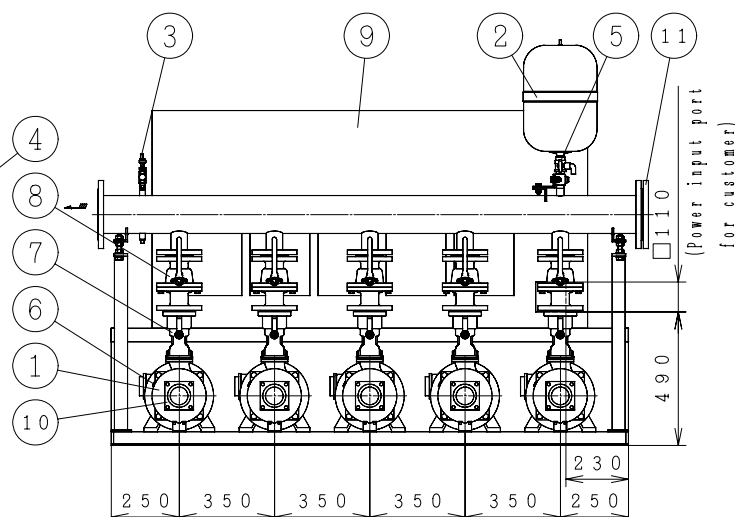
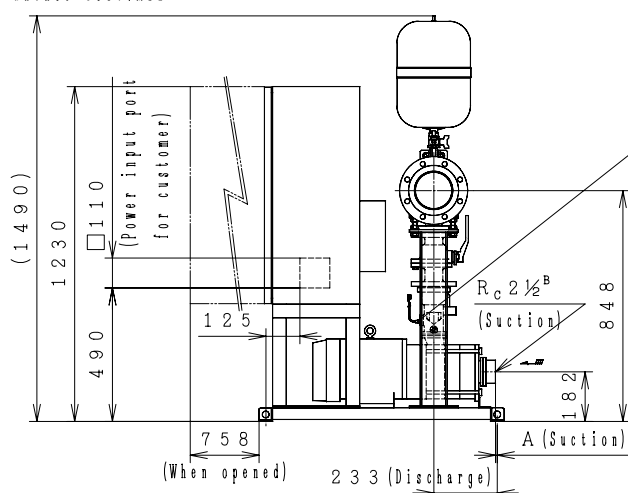

| MODEL | OUTPUT kW | A | MAX SPEED (400V) min ⁻¹ | MAX SPEED (380V) min ⁻¹ | MASS kg |
|---------------------|--------------|-----|---|---|------------|
| NX-125VFC653-7.5F×5 | 7.5 | 5.5 | 3600 | 3540 | 769 |

A tube of $\phi 10\text{mm}$ ($3/8'$) can be connected to TJ valve.

(Control Panel Size 1600×800×350)

| A C C E S S O R I E S | |
|-----------------------|--|
| | |
| | |
| | |
| | |

| UNIT SPECIFICATION | | | | MOTOR SPECIFICATION | |
|--------------------|---------------------|---------------|----------------------|---------------------|------------|
| CAPACITY | m ³ /min | SIZE | Suc. 65mm/Dis. 125mm | POLE | 2 P |
| TOTAL HEAD | m | FREQUENCY | H z | TYPE | T. E. F. C |
| MAX SPEED | min ⁻¹ | PHASE&VOLTAGE | 3 φ V | OUTPUT | kW×4 |

| I T E M N A M E | I T E M N o . |
|-------------------|-----------------|
| M O D E L | Q U A N T I T Y |