

Volute pumps

SJ4

TERAL



60Hz



TERAL INC.

Applications

- Hot and cold water circulation, General water supply
- Conveyance and distribution of tap water

Features

- ① Energy-saving pump with a Top Runner efficiency (equivalent to IE3) motor.
- ② Low noise by adoption of a 4-pole motor.
- ③ Stable operation is possible within specifications with a wide flow range.
- ④ Simplified structure and B.P.O.(back pull-out) type for easy disassembly and maintenance.
- ⑤ Robust structure for piping load with stable installation because of adoption of upright discharge.
- ⑥ Simple and rigid structure based on rational design allows for reduction in costs, user friendliness, and stable operation.

Description of types

SJ4 - 200 × 150 K 6 45 H - e

① ② ③ ④ ⑤ ⑥ ⑦

- ① Model
- ② Nominal suction diameter (200mm)
- ③ Nominal discharge diameter (150mm)
- ④ Frequency (60Hz)
- ⑤ Output (45kW)
- ⑥ Performance code None : Standard
H : According to customer specified point
- ⑦ Equipped with a Top Runner motor (equivalent to IE3)

Standard specifications

Pumping liquid	Liquid quality	Fresh water
	Liquid temperature	0 ~ 80°C
Total suction head (In case of 20°C)		-6m (Suction port diameter 200: -5m) However, 60% or less of the total head if used with the total head of 10m or less.
Allowable boost pressure		See the Specification table.
Structure	Impeller	Closed
	Shaft seal	Mechanical seal (SiC vs Carbon)
	Bearing	Sealed ball bearing
Material	Impeller	CAC406(40×32M), FC200 (40×32H-80×65) CAC406 or SCS13 (125×100 or more)*1
	Shaft	SUS403
	Casing	FC200 or FCD450*1
Motor	Efficiency	Standard efficiency (equivalent to IE1) 0.4kW Top Runner efficiency (equivalent to IE3) 0.75kW or more
	Starting method	Direct-on-Line start : 7.5kW or less Star-delta start : 11kW or more
	Type	Totally enclosed fan-cooled outdoor type : 0.75kW Totally enclosed fan-cooled indoor type : 1.5kW or more
	Power source	3-phase, 200/220V
	Synchronous rotation speed	1800min ⁻¹
Flange spec		JIS 10K standard type
Paint color		7.5BG5/1.5

*1 The material differs according to the type.

Standard accessories

Motor	1
Common base	1
Priming plug	1
Coupling	1 set
Coupling cover	1

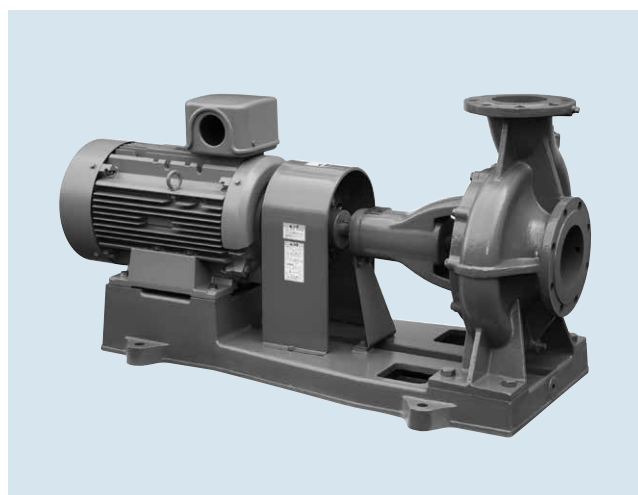

* Please note that some of the devices in the photo may differ from actual devices in coating color, etc.

Special specifications

Structure	Shaft seal	Mechanical seal (SiC vs SiC) Grand packing system
	Other	Drain (below gland/below casing) Sealed coupling cover, No common base
Material	Impeller	CAC406 (40×32H-80×65)
	Shaft	SUS304
Motor	Other	All steel made
	Type	Totally enclosed fan-cooled outdoor type 1.5kW or more
Paint	Power supply	Voltage change
		Specified color for outer surface, salt-resistant paint, heavy-duty salt-resistant paint Japan Sewage Works Agency specifications

* Please note that in case of special specifications, the assembly drawing, etc., may differ from the standard drawing.

Special accessories

Foot valve
Suction cover
Sluice valve, Check valve Bolt, nut, and packing included
Companion flange Bolt, nut, and packing included
Special companion flange (when adjusting the discharge diameter to the suction diameter) Bolt and nut included
Tube with different diameter See the figure below
Vibration isolator
Pressure gauge, vacuum gauge, compound gauge Cock and pipe included
Vibration isolation joint

Foot valve, pipe reducer, special companion flange application table

Nominal diameter	Foot valve nominal diameter	Pipe reducer	Special companion flange
Suction s	Discharge d		
40	32	40	32/40
50	40	50	40/50
65	50	65	50/65
80	65	100	80/100
125	100	150	125/150
150	125	200	150/200
200	200	250	200/250
200	150	250	200/250

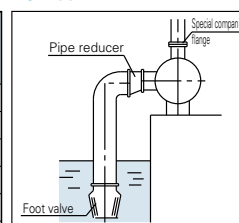

* Special companion flange is used to adjust the discharge diameter to the suction diameter.

Selection chart

● 80×65 or less

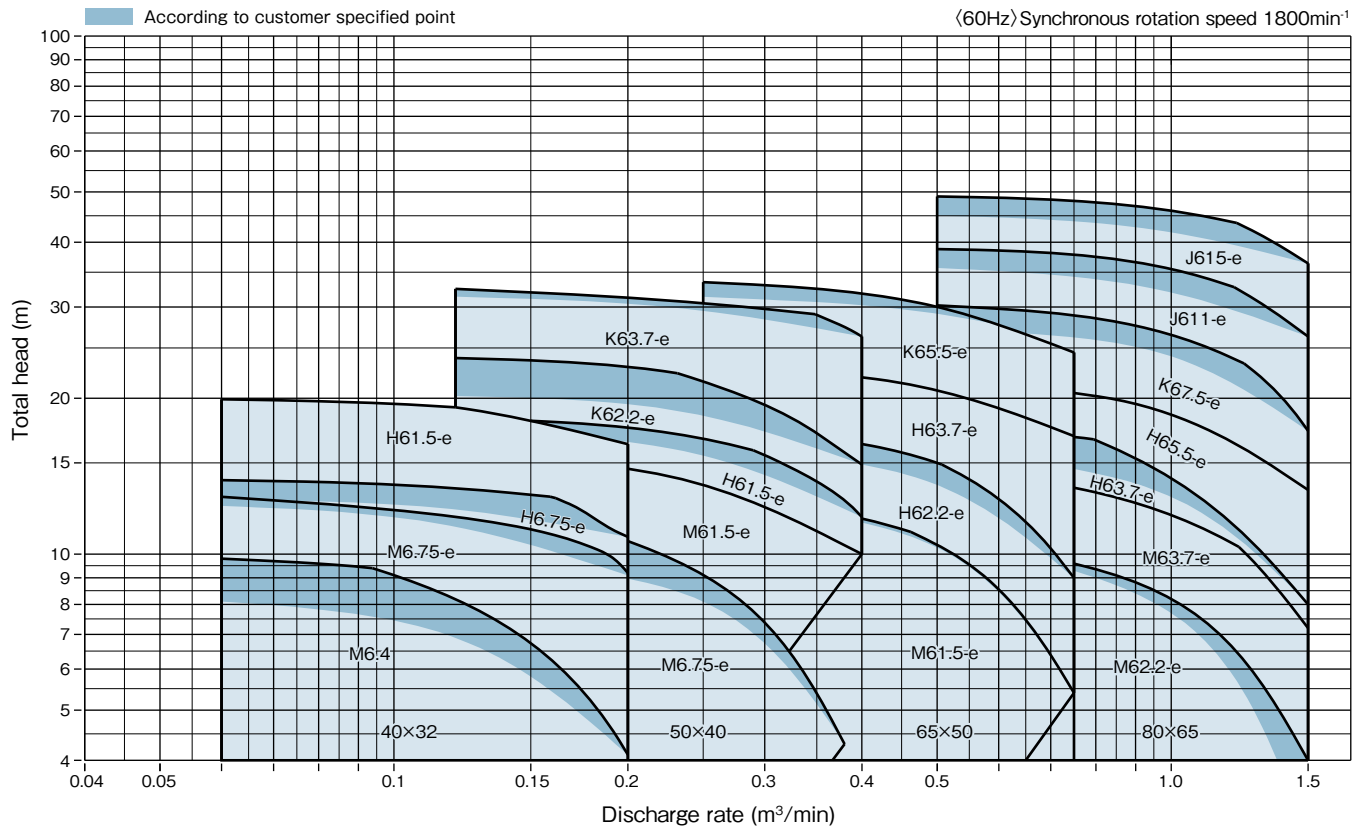

● 125×100 or more

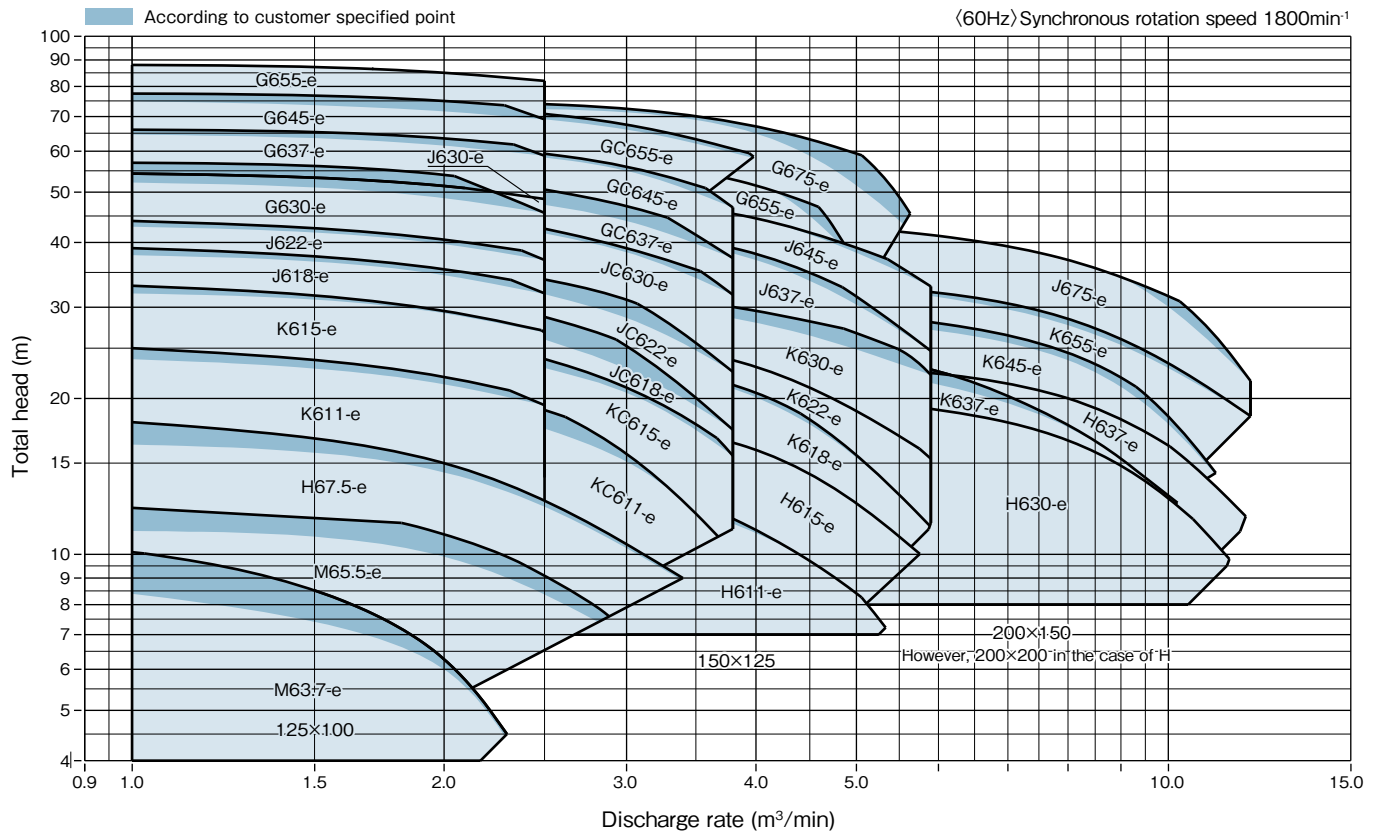

Specifications

Nominal diameter mm		Type	Output kW	Specifications		
Suction	Discharge			Discharge rate m³/min	Total head m	Allowable boost pressure MPa
40	32	SJ4-40×32M6.4	0.4	0.12	6.9	1.02
		SJ4-40×32M6.4H	0.4	—	—	—
		SJ4-40×32M6.75-e	0.75	0.12	11.3	0.97
		SJ4-40×32M6.75H-e	0.75	—	—	—
		SJ4-40×32H6.75-e	0.75	0.12	12.2	0.97
		SJ4-40×32H6.75H-e	0.75	—	—	—
		SJ4-40×32H6.15-e	1.5	0.12	19.2	0.90
50	40	SJ4-50×40M6.75-e	0.75	0.25	8	1.00
		SJ4-50×40M6.75H-e	0.75	—	—	—
		SJ4-50×40M6.15-e	1.5	0.25	13.5	0.94
		SJ4-50×40H6.15-e	1.5	0.25	15.5	0.93
		SJ4-50×40H6.15H-e	1.5	—	—	—
		SJ4-50×40K62.2-e	2.2	0.25	18.4	0.89
		SJ4-50×40K62.2H-e	2.2	—	—	—
		SJ4-50×40K63.7-e	3.7	0.25	29.5	0.78
		SJ4-50×40K63.7H-e	3.7	—	—	—
65	50	SJ4-65×50M6.15-e	1.5	0.5	10.1	0.97
		SJ4-65×50M6.15H-e	1.5	—	—	—
		SJ4-65×50H62.2-e	2.2	0.5	13.6	0.94
		SJ4-65×50H62.2H-e	2.2	—	—	—
		SJ4-65×50H63.7-e	3.7	0.5	20.6	0.87
		SJ4-65×50K65.5-e	5.5	0.5	28.5	0.79
		SJ4-65×50K65.5H-e	5.5	—	—	—
80	65	SJ4-80×65M62.2-e	2.2	1	7.7	0.99
		SJ4-80×65M62.2H-e	2.2	—	—	—
		SJ4-80×65M63.7-e	3.7	1	11.8	0.94
		SJ4-80×65H63.7-e	3.7	1	12.8	0.94
		SJ4-80×65H63.7H-e	3.7	—	—	—
		SJ4-80×65H65.5-e	5.5	1	18.6	0.88
		SJ4-80×65K67.5-e	7.5	1	24	0.84
		SJ4-80×65K67.5H-e	7.5	—	—	—
		SJ4-80×65J611-e	11	1	32	0.75
		SJ4-80×65J611H-e	11	—	—	—
		SJ4-80×65J615-e	15	1	41.8	0.65
		SJ4-80×65J615H-e	15	—	—	—
125	100	SJ4-125×100M63.7-e	3.7	2	6	1.28
		SJ4-125×100M63.7H-e	3.7	—	—	—
		SJ4-125×100M65.5-e	5.5	2	9.9	1.27
		SJ4-125×100M65.5H-e	5.5	—	—	—
		SJ4-125×100H67.5-e	7.5	2	14.4	1.21
		SJ4-125×100H67.5H-e	7.5	—	—	—
		SJ4-125×100K611-e	11	2	21.3	1.14
		SJ4-125×100K611H-e	11	—	—	—
		SJ4-125×100KC611-e	11	3	15	1.16
		SJ4-125×100KC611H-e	11	—	—	—
		SJ4-125×100K615-e	15	2	29.2	1.07
		SJ4-125×100K615H-e	15	—	—	—
		SJ4-125×100KC615-e	15	3	20.6	1.11
		SJ4-125×100KC615H-e	15	—	—	—
		SJ4-125×100J618-e	18.5	2	34.6	1.00
		SJ4-125×100J618H-e	18.5	—	—	—

Nominal diameter mm		Type	Output kW	Specifications		
Suction	Discharge			Discharge rate m³/min	Total head m	Allowable boost pressure MPa
125	100	SJ4-125×100JC618-e	18.5	3	23	1.06
		SJ4-125×100JC618H-e	18.5	—	—	—
		SJ4-125×100J622-e	22	2	39.7	0.96
		SJ4-125×100J622H-e	22	—	—	—
		SJ4-125×100JC622-e	22	3	28.5	1.01
		SJ4-125×100JC622H-e	22	—	—	—
		SJ4-125×100J630-e	30	2	51.3	0.84
		SJ4-125×100JC630-e	30	3	38.3	0.91
		SJ4-125×100JC630H-e	30	—	—	—
		SJ4-125×100G630-e	30	2	48.8	0.86
		SJ4-125×100G630H-e	30	—	—	—
		SJ4-125×100G637-e	37	2	61.5	0.74
		SJ4-125×100G637H-e	37	—	—	—
		SJ4-125×100GC637-e	37	3	44	0.85
		SJ4-125×100GC637H-e	37	—	—	—
		SJ4-125×100G645-e	45	2	71.5	0.62
		SJ4-125×100G645H-e	45	—	—	—
		SJ4-125×100GC645-e	45	3	55	0.76
		SJ4-125×100GC645H-e	45	—	—	—
		SJ4-125×100G655-e	55	2	85	0.50
		SJ4-125×100GC655-e	55	3	66.1	0.65
		SJ4-125×100GC655H-e	55	—	—	—
150	125	SJ4-150×125H611-e	11	4	10.9	1.22
		SJ4-150×125H611H-e	11	—	—	—
		SJ4-150×125H615-e	15	4	15.9	1.18
		SJ4-150×125K618-e	18.5	4	19.9	1.11
		SJ4-150×125K618H-e	18.5	—	—	—
		SJ4-150×125K622-e	22	4	23	1.07
		SJ4-150×125K622H-e	22	—	—	—
		SJ4-150×125K630-e	30	4	27.9	1.07
		SJ4-150×125K630H-e	30	—	—	—
		SJ4-150×125J637-e	37	4	36.2	0.94
		SJ4-150×125J637H-e	37	—	—	—
		SJ4-150×125J645-e	45	4	44.6	0.86
		SJ4-150×125J645H-e	45	—	—	—
		SJ4-150×125G655-e	55	4	51.5	0.77
		SJ4-150×125G655H-e	55	—	—	—
		SJ4-150×125G675-e	75	4	64.8	0.61
		SJ4-150×125G675H-e	75	—	—	—
200	200	SJ4-200×200H630-e	30	8	16.6	1.18
		SJ4-200×200H637-e	37	8	20	1.15
	150	SJ4-200×150K637-e	37	8	17.6	1.11
		SJ4-200×150K637H-e	37	—	—	—
		SJ4-200×150K645-e	45	8	23.6	1.10
		SJ4-200×150K645H-e	45	—	—	—
		SJ4-200×150K655-e	55	8	27.7	1.02
		SJ4-200×150K655H-e	55	—	—	—
		SJ4-200×150J675-e	75	8	37	0.94
		SJ4-200×150J675H-e	75	—	—	—

■ Assembly drawing

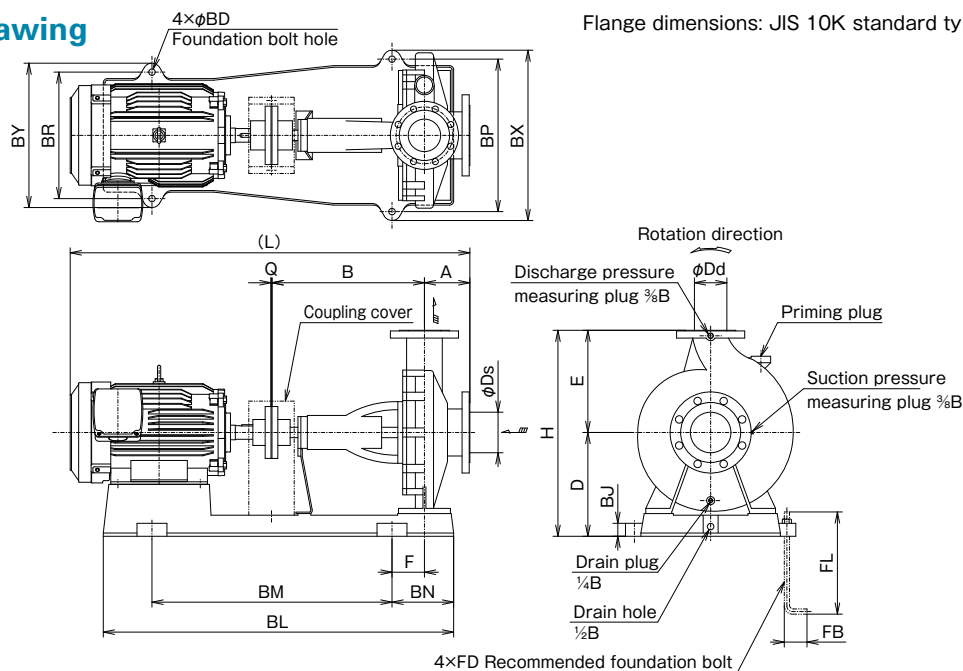

Flange dimensions: JIS 10K standard type or equivalent

Note) Overall length dimensions, approximate mass and terminal box position may vary depending on the motor manufacturer.

■ Dimensions

(Unit: mm)

Nominal diameter Suction Ds	Discharge Dd	Type	Output kW	Pump / Motor								Common base								Foundation bolt				Approx. mass kg
				A	B	D	E	F	H	L	Q	BD	BJ	BL	BM	BN	BP	BR	BX	BY	FB	FD	FL	
40	32	SJ4-40×32M6.4(H)	0.4	80	360	182	160	45	342	686	3	13	25	615	420	105	290	210	325	245	45	M10	200	49
		SJ4-40×32M6.75(H)-e	0.75	80	360	182	160	45	342	705	3	13	25	640	420	105	290	240	325	275	45	M10	200	60
		SJ4-40×32H6.75(H)-e	0.75	80	360	215	180	45	395	705	3	15	30	640	420	105	320	240	365	285	55	M12	250	65
		SJ4-40×32H61.5-e	1.5	80	360	215	180	40	395	755	3	15	30	700	480	115	335	245	380	290	55	M12	250	73
50	40	SJ4-50×40M6.75(H)-e	0.75	80	360	182	160	45	342	705	3	13	25	640	420	105	290	240	325	275	45	M10	200	61
		SJ4-50×40M61.5-e	1.5	80	360	182	160	55	342	755	3	13	25	685	480	115	290	235	325	270	45	M10	200	68
		SJ4-50×40H61.5(H)-e	1.5	100	360	215	180	40	395	775	3	15	30	700	480	115	335	245	380	290	55	M12	250	81
		SJ4-50×40K62.2(H)-e	2.2	100	360	235	225	40	460	829	3	16	30	740	480	115	375	275	420	320	55	M12	250	95
65	50	SJ4-50×40K63.7(H)-e	3.7	100	360	235	225	55	460	844	3	15	30	740	540	130	375	295	420	340	55	M12	250	107
		SJ4-65×50M61.5(H)-e	1.5	100	360	215	180	40	395	775	3	15	30	700	480	115	335	245	380	290	55	M12	250	79
		SJ4-65×50H62.2(H)-e	2.2	100	360	215	200	40	415	829	3	16	30	740	480	115	335	265	380	310	55	M12	250	93
		SJ4-65×50H63.7-e	3.7	100	360	215	200	55	415	844	3	15	30	740	540	130	335	290	380	335	55	M12	250	106
80	65	SJ4-65×50K65.5(H)-e	5.5	100	360	250	225	75	475	914	3	20	40	825	600	150	390	340	445	395	70	M16	315	147
		SJ4-80×65M62.2(H)-e	2.2	100	360	215	200	40	415	829	3	16	30	740	480	115	335	265	380	310	55	M12	250	93
		SJ4-80×65M63.7-e	3.7	100	360	215	200	55	415	844	3	15	30	740	540	130	335	290	380	335	55	M12	250	105
		SJ4-80×65H63.7(H)-e	3.7	100	360	235	225	55	460	844	3	15	30	740	540	130	375	295	420	340	55	M12	250	127
125	100	SJ4-80×65H65.5-e	5.5	100	360	250	225	75	475	914	3	20	40	825	600	150	390	340	445	395	70	M16	315	151
		SJ4-80×65K67.5(H)-e	7.5	100	470	270	250	80	520	1062	3	20	40	950	660	170	430	340	485	395	70	M16	315	170
		SJ4-80×65J611(H)-e	11	125	470	320	280	100	600	1222	3	20	40	1080	740	190	470	390	525	445	70	M16	315	278
		SJ4-80×65J615(H)-e	15	125	470	320	280	100	600	1272	3	20	40	1080	740	190	470	390	525	445	70	M16	315	291
150	125	SJ4-125×100M63.7(H)-e	3.7	125	470	270	250	60	520	979	3	20	40	870	600	150	430	310	485	365	70	M16	315	147
		SJ4-125×100M65.5(H)-e	5.5	125	470	270	250	80	520	1049	3	20	40	950	660	170	430	340	485	395	70	M16	315	167
		SJ4-125×100H67.5(H)-e	7.5	125	470	270	280	80	550	1087	3	20	40	950	660	170	430	340	485	395	70	M16	315	177
		SJ4-125×100K611(H)-e	11	140	470	320	280	100	600	1237	3	20	40	1080	740	190	470	390	525	445	70	M16	315	275
		SJ4-125×100K615(H)-e	11	140	470	320	280	100	600	1237	3	20	40	1080	740	190	470	390	525	445	70	M16	315	281
		SJ4-125×100K615(H)-e	15	140	470	320	280	100	600	1267	3	20	40	1080	740	190	470	390	525	445	70	M16	315	294
		SJ4-125×100K615(H)-e	15	140	470	320	280	100	600	1287	3	20	40	1080	740	190	470	390	525	445	70	M16	315	294
		SJ4-125×100J618(H)-e	18.5	140	470	330	315	115	645	1286	3	25	50	1120	840	205	480	440	550	510	90	M20	400	344
		SJ4-125×100J618(H)-e	18.5	140	470	330	315	115	645	1286	3	25	50	1120	840	205	480	440	550	510	90	M20	400	344
		SJ4-125×100J622(H)-e	22	140	470	330	315	115	645	1286	3	25	50	1120	840	205	480	440	550	510	90	M20	400	353
		SJ4-125×100J622(H)-e	22	140	470	330	315	115	645	1286	3	25	50	1120	840	205	480	440	550	510	90	M20	400	353
		SJ4-125×100J630-e	30	140	470	330	315	115	645	1325	4	25	50	1120	840	205	480	440	550	510	90	M20	400	387
		SJ4-125×100J630(H)-e	30	140	470	330	315	115	645	1325	4	25	50	1120	840	205	480	440	550	510	90	M20	400	387
		SJ4-125×100G630(H)-e	30	140	530	360	355	95	715	1385	4	25	50	1200	840	205	580	440	650	510	90	M20	400	446
		SJ4-125×100G637(H)-e	37	140	530	360	355	120	715	1546	4	25	50	1280	940	230	580	490	650	560	90	M20	400	544
		SJ4-125×100G637(H)-e	37	140	530	360	355	120	715	1546	4	25	50	1280	940	230	580	490	650	560	90	M20	400	544
		SJ4-125×100G645(H)-e	45	140	530	360	355	120	715	1546	4	25	50	1280	940	230	580	490	650	560	90	M20	400	569
200	150	SJ4-125×100G645(H)-e	45	140	530	360	355	120	715	1546	4	25	50	1280	940	230	580	490	650	560	90	M20	400	569
		SJ4-150×125H611(H)-e	11	140	470	320	315	100	635	1257	3	20	40	1080	740	190	470	390	525	445	70	M16	315	289
		SJ4-150×125H615-e	15	140	470	320	315	100	635	1287	3	20	40	1080	740	190	470	390	525	445	70	M16	315	302
		SJ4-150×125K618(H)-e	18.5	140	470	330	355	115	685	1286	3	25	50	1120	840	205	480	440	550	510	90	M20	400	367
		SJ4-150×125K618(H)-e	22	140	470	330	355	115	685	1286	3	25	50	1120	840	205	480	440	550	510	90	M20	400	376
		SJ4-150×125K630(H)-e	30	140	470	330	355	115	685	1325	4	25	50	1120	840	205	480	440	550	510	90	M20	400	410
		SJ4-150×125J637(H)-e	37	140	530	360	355	120	715	1546	4	25	50	1280	940	230	580	490	650	560	90	M20	400	577
		SJ4-150×125J645(H)-e	45	140	530	360	355	120	715	1546	4	25	50	1280	940	230	580	490	650	560	90	M20	400	602
200	200	SJ4-200×200H630-e	30	180	530	360	375	95	735	1425	4	25	50	1200	840	205	580	440	650	510	90	M20	400	494
		SJ4-200×200H637-e	37	180	530	360	375	120	735	1586	4	25	50	1280	940	230	580	490	650	560	90	M20	400	592
200	150	SJ4-200×150K637(H)-e	37	160	530	360	375	120	735	1586	4	25	50	1280	940	230	580	490	650	560	90	M20	400	583
		SJ4-200×150K645(H)-e	45	160	530	360	375	120	735	1586	4	25	50	1280	940	230	580	490	650	560	90	M20	400	608

*Mounting dimensions are compatible with SJ4 model (product equipped with totally enclosed fan-cooled IE1 motor). Also the motor frame number is the same. Therefore, replacement with a Top Runner efficiency (equivalent to IE3) motor is possible. However, please keep the following point in mind. The number of revolutions will increase because of the characteristics of the motor, which may cause the flow rate to exceed the rated current value. Please adjust the flow rate to use the motor within the rated current value.

*For products equipped with a drip-proof protection type motor, there are some types which also require a common base because the frame No. may be different when only the motor is replaced.

Assembly drawing

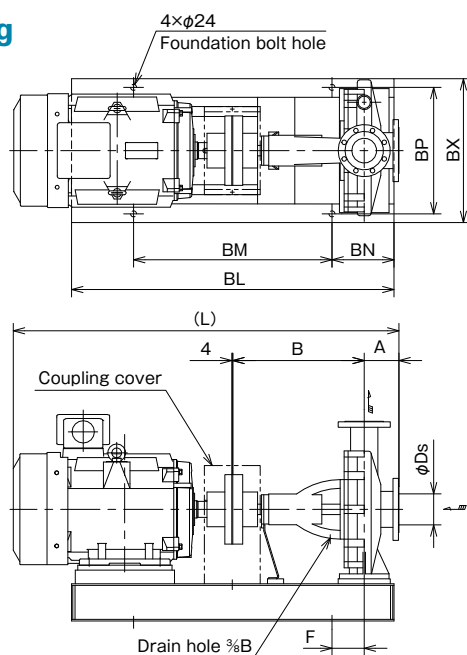

Flange dimensions: JIS 10K standard type or equivalent

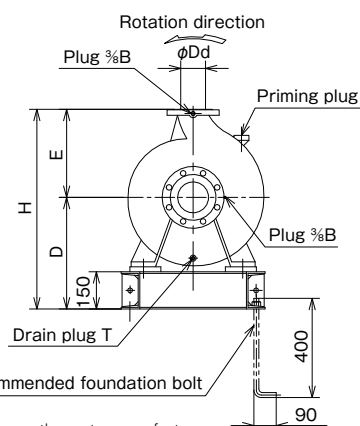

Note) Total length dimension and approximate mass may vary slightly depending on the motor manufacturer.

Dimensions

(Unit: mm)

Nominal diameter Suction Ds	Discharge Dd	Type	Output kW	Pump / Motor								Common base					Approx. mass kg
				A	B	D	E	F	H	L	T	BL	BM	BN	BP	BX	
125	100	SJ4-125×100G655-e	55	140	530	450	355	130	805	1555	1/2B	1300	800	250	510	580	760
		SJ4-125×100GC655(H)-e	55	140	530	450	355	130	805	1555	1/2B	1300	800	250	510	580	760
150	125	SJ4-150×125G675(H)-e	75	140	530	485	400	135	885	1692	3/4B	1400	900	250	510	580	938
		SJ4-200×150K655(H)-e	55	160	530	450	375	130	825	1575	3/4B	1300	800	250	510	580	700
200	150	SJ4-200×150J675(H)-e	75	160	670	485	400	155	885	1852	3/4B	1550	1000	275	570	640	1000

*Mounting dimensions are compatible with SJ4 model (product equipped with totally enclosed fan-cooled IE1 motor). Also the motor frame number is the same. Therefore, replacement with a Top Runner efficiency (equivalent to IE3) motor is possible. However, please keep the following point in mind. The number of revolutions will increase because of the characteristics of the motor, which may cause the flow rate to exceed the rated current value. Please adjust the flow rate to use the motor within the rated current value.

*For products equipped with a drip-proof protection type motor, there are some types which also require a common base because the frame No. may be different when only the motor is replaced.

Example of sectional drawing

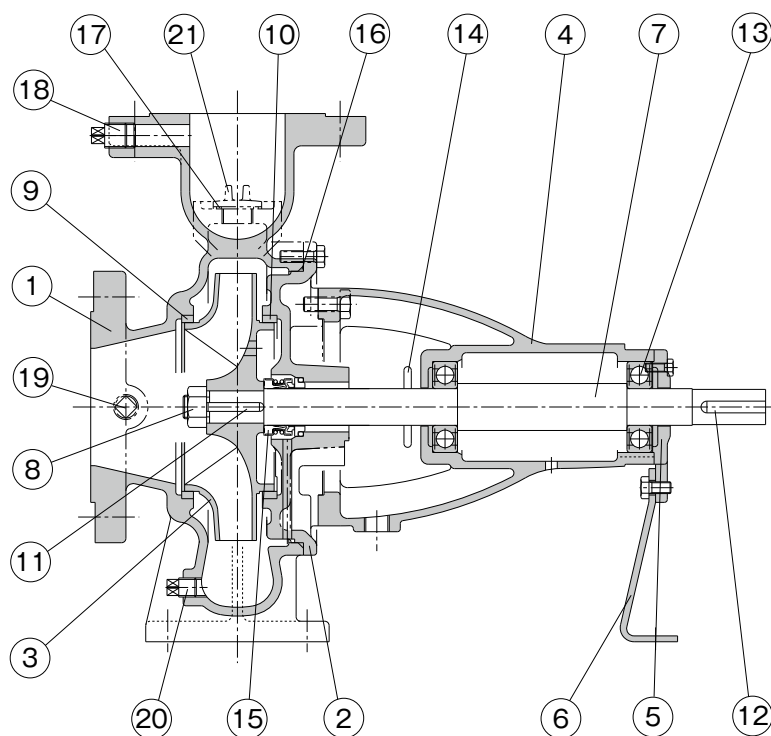

Parts list

No.	Part name	Qty	Material
1	Casing	1	FC200/FCD450
2	Casing cover	1	FC200
3	Impeller	1	FC200/CAC406/SCS13
4	Bearing case	1	FC200
5	Bearing cover	1	FC200
6	Mounting leg	1	SS400
7	Main shaft	1	SUS403
8	Impeller nut	1	SUS304
9	Liner ring	1	CAC406
10	Liner ring	1	CAC406
11	Impeller key	1	SUS304
12	Coupling key	1	S45C
13	Ball bearing	2	SUJ2
14	Deflector	1	CR
15	Mechanical seal	1	SiC vs Carbon
16	O-ring	1	NBR
17	O-ring	1	NBR
18	Plug A	1	SWCH
19	Plug B	1	SWCH
20	Drain plug	1	SWCH
21	Priming plug	1	C3771B

* Note) This is a representative example. For details, see the sectional drawing of each model.

[illegible]



TERAL INC.

Head Office 230, Moriwake, Miyuki-cyo, Fukuyama-city, Hiroshima, 720-0003, Japan
Tel.+81-84-955-1111 Fax.+81-84-955-5777
www.teral.net

Teral Asia Limited

Room 1001,10/F, Olympia Plaza, 255 King's Road, North Point, Hong Kong
Tel.+852-2571-0935 Fax.+852-2571-0619

TERAL THAI CO.,LTD.

150 Moo 16 Udomsoraryuth Rd., T.Bangkrasan, A.Bangpa-In, Ayutthaya 13160 Thailand
Tel.+66-3535-2148-9 Fax.+66-3535-2150

TERAL TRADING & SERVICE CO.,LTD.

150 Moo 16 Udomsoraryuth Rd., T.Bangkrasan, A.Bangpa-In, Ayutthaya 13160 Thailand
Tel.+66-3535-2145-7 Fax.+66-3535-8549

Teral Malaysia Sdn.Bhd.

10, Jalan SS13/6A, Subang Jaya Industrial Estate, 47500, Subang Jaya, Selangor D.E, Malaysia
Tel.+60-3-5611 5775 Fax.+60-3-5612 5775

PT.Teral Indonesia Pumps and Fans

Komplek Pergudangan Taman Tekno Blok M No.26.Jl.BSD Sektor XI, Kelurahan Setu,
Kecamatan Setu, Kota Tangerang Selatan, Provinsi Banten.15314.
Tel.+62-21-29665778 Fax.+62-21-75673913

Teral Vietnam Limited Liability Company

9th Floor, LADECO Building, No. 266 Doi Can Street, Lieu Giai Ward, Ba Dinh District, Hanoi City, Vietnam
Tel.+84-24-393-52-790 Fax.+84-24-393-52-289

Teral General Machine (Shanghai) Co.,Ltd.

No.285, Yuan Qu Road(N), Bei Qiao, Min Hang District, Shanghai 201109, China
Tel.+86-21-6490-9128 Fax.+86-21-6490-9126

Teral-Aerotech Fans Private Ltd.

Plot No.188-189, Ecotech Extension-1, Surajpur Kasna Road, Greater Noida-201306, Uttar Pradesh, India
Tel.+91-9810162210, +91-9310162210

Teral Middle East F.Z.C.

1806-002, 18th floor, BB1, Mazaya Business Avenue, JLT, Dubai, UAE. PO Box 414781
Tel.+971-4369 9039

Teral Pumps & Fans North America Ltd.

Suite # 197, 800-15355 24 Ave Surrey, B.C., CANADA V4A 2H9
Tel.+1-604-839-1008

Teral Philippines Inc.

Roof Deck 3, Vernida 1 Building, 120 Amorsolo St., Legaspi Village, Makati City
Tel.+63 2 7717-9314