

Volute pumps

SJ4S

TERAL



60Hz

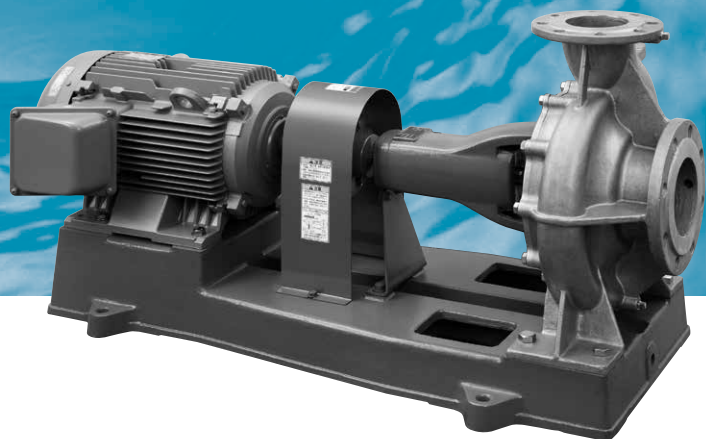

TERAL INC.

Applications

- General water supply
- Industrial use
- Circulation of cold/warm water
- Conveyance of industrial water
- Conveyance and distribution of tap water
- Other uses

Features

- ① Energy-saving pump with a Top Runner efficiency (equivalent to IE3) motor
- ② Stainless steel on the wetted part
These pumps can be used for a wide range of applications from measures against rusty water to paint liquid.
- ③ Diverse shaft seal specifications
Mechanical seal comes as standard. For special specifications, gland packings and double mechanical seal are supported.
- ④ Easy maintenance
These pumps have a simple structure and the BPO (Back Pullout) method. Therefore, it is easy to disassemble and inspect.
- ⑤ Highly rigid structure
The overhead discharge design enables stable installment, and the structure which withstands pipe loads well.
- ⑥ Compatible mounting dimensions with conventional pumps

Description of types

SJ4S 50 × 40 K 6 2.2 - e

- ① Model
- ② Suction diameter
- ③ Discharge diameter
- ④ Head K : Low head
J, JC : High head
- ⑤ Frequency (5:50Hz, 6:60Hz)
- ⑥ Output
- ⑦ Top Runner efficiency (equivalent to IE3)

Standard specifications

Pumping liquid	Liquid quality	Fresh water and special liquid ※1
	Liquid temperature	0~80°C※2
Total suction head (In case of 20°C)		-6m. However, 60% or less of the total head when the pump is used with 10m or less total head.
Allowable boost pressure		See the specification table.
Structure	Impeller	Closed
	Shaft seal	Mechanical seal (SiC vs Carbon)
	Bearing	Sealed ball bearing
Material	Casing	SCS13
	Casing cover	SCS13
	Impeller	SCS13
	Shaft	SUS304
Motor	Rubber wetted part	NBR
	Efficiency	Top Runner efficiency (equivalent to IE3)
	Starting method	Direct-on-Line start 7.5kW or less Star-delta start 11kW or more
	Type	Totally enclosed fan-cooled indoor type
	Power source	3-phase, 200/220V
Flange spec	Synchronous rotation speed	1800min ⁻¹
		JIS10K standard type

※1 Contact us for the use of special liquid.

※2 When the temperature exceeds 80°C, please contact us.

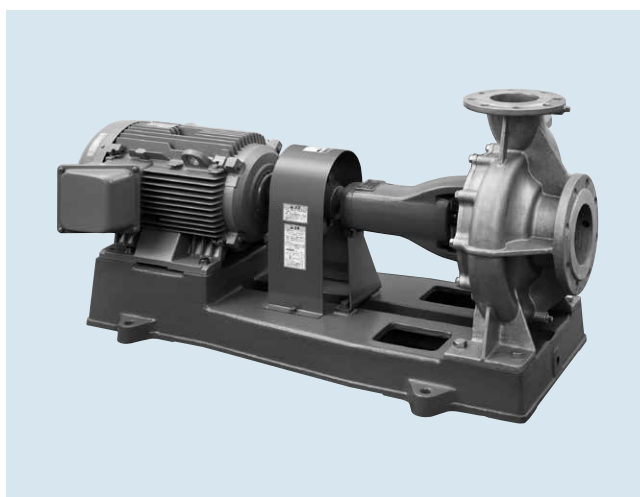

※ Please note that of the devices in the photo may differ from actual devices in coating color, etc.

Standard accessories

Motor	1
Common base	1
Priming plug	1
Coupling	1 set
Coupling cover	1

Special specifications

Structure	Shaft seal	Mechanical seal (SiC vs SiC) Double mechanical seal (rubber wetted part: FKM; liquid temperature: Max. 60°C), Gland packing, External water injection method (when foreign articles are slightly included in the handling liquid)
	Other	Drain (below gland/below casing) Seal type coupling cover, no common base
Paint ※1		Specified color for outer surface, salt-resistant paint, heavy-duty salt-resistant paint
Motor	Type	Totally enclosed fan-cooled outdoor type
	Power supply	Voltage change
Other		Oil-free treatment (Grade I / Grade II)

※ Please note that in case of special specifications, the assembly drawing, etc., may differ from the standard drawing.

※1 No coating for stainless steel parts.

Special accessories

Companion flange (bolt and nut included).....	2 sets
Foot valve	
Suction cover	
Sluice valve, check valve	
Vibration isolator	
Pressure gauge, compound gauge, vacuum gauge	
Vibration isolation joint	



Double mechanical seal specifications which support painting facilities (special specifications)

Features of Double Mechanical Seal Specifications

Highly technical support

These products can support coagulable fluid, such as paint, by circulating flushing fluid between two seal surfaces on the pumping liquid side and the atmospheric side.

Reliability

The specially shaped sliding surface is applied to the inside of the equipment, and it provides high seal performance even for coagulable fluid with high viscosity. Also, since metal bellows are used, these pumps possess excellent followability. You don't have to be worried about operational problems caused by the adherence of paint and the like, and foreign articles.

Easy and safe assembly

It is easy to attach and assemble by adapting the cartridge type. It also prevents the damage on the sliding surface when the parts are assembled into the system.

■ Selection chart

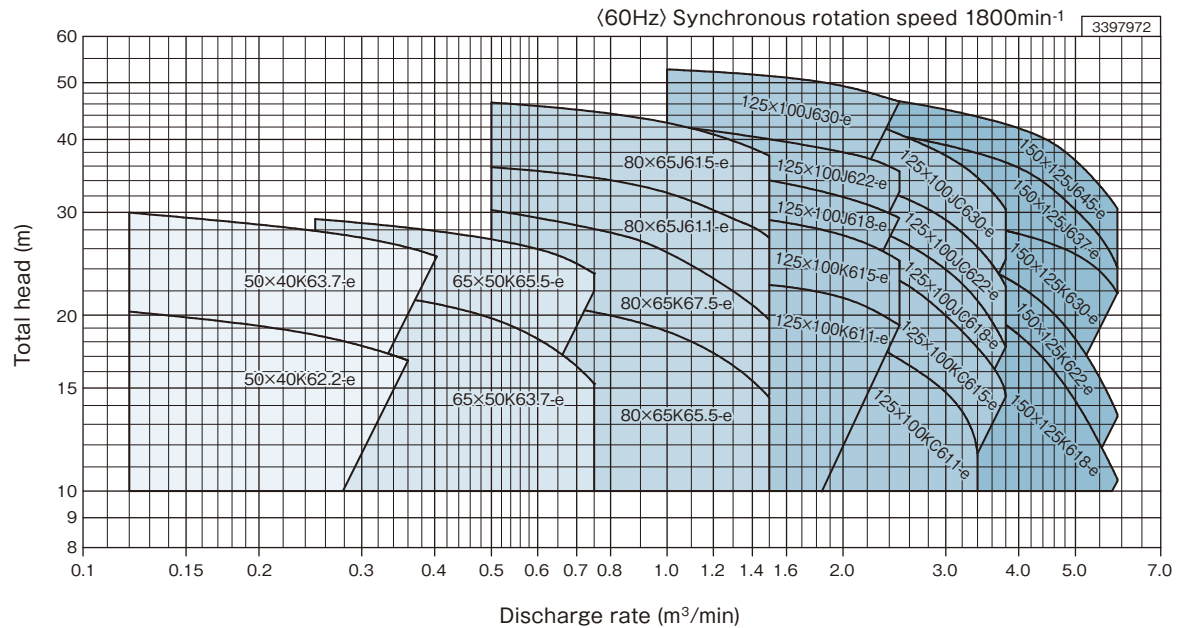

■ Specification table

Nominal diameter (mm)		Type	Output (kW)	Specifications						Allowable boost pressure (MPa)			※ Flushing	
Suction	Discharge			Discharge rate (m ³ /min)	Total head (m)	Discharge rate (m ³ /min)	Total head (m)	Discharge rate (m ³ /min)	Total head (m)	Single mechanical seal	Double mechanical seal	Gland packing	Pressure (MPa)	Flow rate (L/min)
50	40	SJ4S-50 × 40K62.2-e	2.2	0.12	20.3	0.25	18.5	0.36	16.7	0.77	0.41	0.59	0.29	3
		SJ4S-50 × 40K63.7-e	3.7	0.12	29.9	0.25	27.8	0.4	25.2	0.66	0.37	0.59	0.33	3
65	50	SJ4S-65 × 50K63.7-e	3.7	0.25	22.3	0.5	19.7	0.75	15.2	0.76	0.40	0.59	0.30	4
		SJ4S-65 × 50K65.5-e	5.5	0.25	29.2	0.5	27.0	0.75	23.6	0.69	0.37	0.59	0.32	4
80	65	SJ4S-80 × 65K65.5-e	5.5	0.5	21.4	1.0	18.7	1.5	14.4	0.77	0.37	0.59	0.33	4
		SJ4S-80 × 65K67.5-e	7.5	0.5	30.2	1.0	25.6	1.5	19.6	0.68	0.37	0.59	0.33	4
		SJ4S-80 × 65J611-e	11	0.5	35.8	1.0	32.4	1.5	27.0	0.62	0.35	0.59	0.35	4
		SJ4S-80 × 65J615-e	15	0.5	46.2	1.0	42.6	1.5	37.4	0.52	0.30	0.59	0.39	4
125	100	SJ4S-125 × 100K611-e	11	1.0	23.1	2.0	21.3	2.5	19.2	0.66	0.40	0.59	0.30	4
		SJ4S-125 × 100KC611-e	11	2.3	17.6	3.0	14.7	3.4	12.0	0.67	0.41	0.59	0.29	4
		SJ4S-125 × 100K615-e	15	1.0	30.4	2.0	27.3	2.5	24.6	0.59	0.37	0.59	0.32	4
		SJ4S-125 × 100KC615-e	15	2.3	23.8	3.0	19.9	3.8	14.9	0.61	0.38	0.59	0.32	4
		SJ4S-125 × 100J618-e	18.5	1.0	36.1	2.0	31.8	2.5	29.2	0.63	0.35	0.59	0.35	4
		SJ4S-125 × 100JC618-e	18.5	2.3	27.8	3.0	23.7	3.8	17.6	0.66	0.36	0.59	0.33	4
		SJ4S-125 × 100J622-e	22	1.0	42.2	2.0	37.9	2.5	35.3	0.57	0.32	0.59	0.37	4
		SJ4S-125 × 100JC622-e	22	2.3	32.9	3.0	29.1	3.8	22.4	0.61	0.34	0.59	0.35	4
		SJ4S-125 × 100J630-e	30	1.0	52.7	2.0	49.1	2.5	46.4	0.46	0.27	0.59	0.42	4
150	125	SJ4S-125 × 100JC630-e	30	2.3	42.1	3.0	37.4	3.8	30.4	0.51	0.30	0.59	0.39	4
		SJ4S-150 × 125K618-e	18.5	2.0	24.3	4.0	18.4	5.9	10.4	0.73	0.39	0.69	0.31	4
		SJ4S-150 × 125K622-e	22	2.0	27.7	4.0	22.4	5.9	13.5	0.70	0.38	0.69	0.32	4
		SJ4S-150 × 125K630-e	30	2.0	30.7	4.0	27.5	5.9	21.9	0.69	0.36	0.69	0.33	4
		SJ4S-150 × 125J637-e	37	2.0	41.5	4.0	35.7	5.9	24.2	0.77	0.33	0.69	0.37	6
		SJ4S-150 × 125J645-e	45	2.0	47.7	4.0	41.7	5.9	30.5	0.71	0.30	0.69	0.40	6

※ It applies only to the double mechanical seal specifications.

Assembly drawing

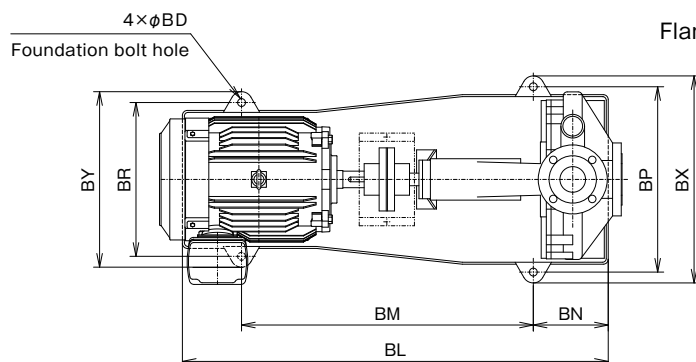

Flange dimensions: JIS 10K standard type or equivalent

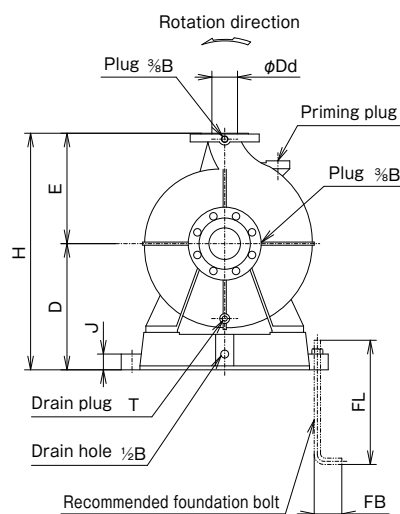
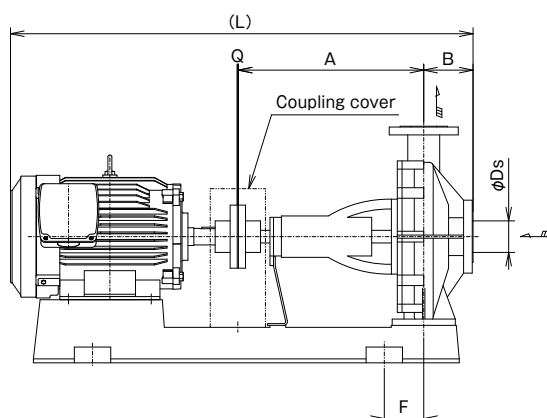

Note) Total length dimension, approximate mass and terminal box position may be slightly different depending on motor manufacturer. The coupling cover is included in the standard accessories.

Dimensions

Unit (mm)

Nominal diameter (mm)		Type	Output (kW)	Pump / Motor								Common base										Foundation bolt			Approx mass (kg)
Ds	Dd			A	B	D	E	H	F	L	Q	T	J	BD	BL	BM	BN	BP	BR	BX	BY	FB	FD	FL	
50	40	SJ4S-50 × 40K62.2-e	2.2	360	100	235	225	460	40	829	3	¼B	30	16	740	480	115	375	275	420	320	55	M12	250	99
		SJ4S-50 × 40K63.7-e	3.7	360	100	235	225	460	55	844	3	¼B	30	15	740	540	130	375	295	420	340	55	M12	250	109
65	50	SJ4S-65 × 50K63.7-e	3.7	360	100	235	225	460	55	844	3	¼B	30	15	740	540	130	375	295	420	340	55	M12	250	114
		SJ4S-65 × 50K65.5-e	5.5	360	100	250	225	475	75	914	3	¼B	40	20	825	600	150	390	340	445	395	70	M16	315	132
80	65	SJ4S-80 × 65K65.5-e	5.5	470	100	270	250	520	80	1024	3	¼B	40	20	950	660	170	430	340	485	395	70	M16	315	153
		SJ4S-80 × 65K67.5-e	7.5	470	100	270	250	520	80	1062	3	¼B	40	20	950	660	170	430	340	485	395	70	M16	315	162
		SJ4S-80 × 65J611-e	11	470	125	320	280	600	100	1242	3	¼B	40	20	1080	740	190	470	390	525	445	70	M16	315	257
		SJ4S-80 × 65J615-e	15	470	125	320	280	600	100	1272	3	¼B	40	20	1080	740	190	470	390	525	445	70	M16	315	270
125	100	SJ4S-125 × 100K611-e	11	470	140	320	280	600	100	1257	3	¼B	40	20	1080	740	190	470	390	525	445	70	M16	315	257
		SJ4S-125 × 100KC611-e	11	470	140	320	280	600	100	1257	3	¼B	40	20	1080	740	190	470	390	525	445	70	M16	315	257
		SJ4S-125 × 100K615-e	15	470	140	320	280	600	100	1287	3	¼B	40	20	1080	740	190	470	390	525	445	70	M16	315	270
		SJ4S-125 × 100KC615-e	15	470	140	320	280	600	100	1287	3	¼B	40	20	1080	740	190	470	390	525	445	70	M16	315	270
		SJ4S-125 × 100J618-e	18.5	470	140	330	315	645	115	1286	3	¼B	50	25	1120	840	205	480	440	550	510	90	M20	400	346
		SJ4S-125 × 100JC618-e	18.5	470	140	330	315	645	115	1286	3	¼B	50	25	1120	840	205	480	440	550	510	90	M20	400	346
		SJ4S-125 × 100J622-e	22	470	140	330	315	645	115	1286	3	¼B	50	25	1120	840	205	480	440	550	510	90	M20	400	356
		SJ4S-125 × 100JC622-e	22	470	140	330	315	645	115	1286	3	¼B	50	25	1120	840	205	480	440	550	510	90	M20	400	356
		SJ4S-125 × 100J630-e	30	470	140	330	315	645	115	1325	4	¼B	50	25	1120	840	205	480	440	550	510	90	M20	400	391
		SJ4S-125 × 100JC630-e	30	470	140	330	315	645	115	1325	4	¼B	50	25	1120	840	205	480	440	550	510	90	M20	400	391
150	125	SJ4S-150 × 125K618-e	18.5	470	140	330	355	685	115	1286	3	¾B	50	25	1120	840	205	480	440	550	510	90	M20	400	353
		SJ4S-150 × 125K622-e	22	470	140	330	355	685	115	1286	3	¾B	50	25	1120	840	205	480	440	550	510	90	M20	400	362
		SJ4S-150 × 125K630-e	30	470	140	330	355	685	115	1325	4	¾B	50	25	1120	840	205	480	440	550	510	90	M20	400	396
		SJ4S-150 × 125J637-e	37	530	140	360	355	715	120	1546	4	¾B	50	25	1280	940	230	580	490	650	560	90	M20	400	552
		SJ4S-150 × 125J645-e	45	530	140	360	355	715	120	1546	4	¾B	50	25	1280	940	230	580	490	650	560	90	M20	400	587

※ Mounting dimension is compatible with SJ4S type (product equipped with totally enclosed fan-cooled IE1 motor). In addition, the motor frame No. is the same, so it is possible to replace with a top runner (equivalent to IE3) motor. However, pay attention to the following. The rotation speed of the motor increases because of its characteristics.

Therefore adjust the flow rate and use the product so that the current should not exceed the rated current.

■Example of sectional drawing

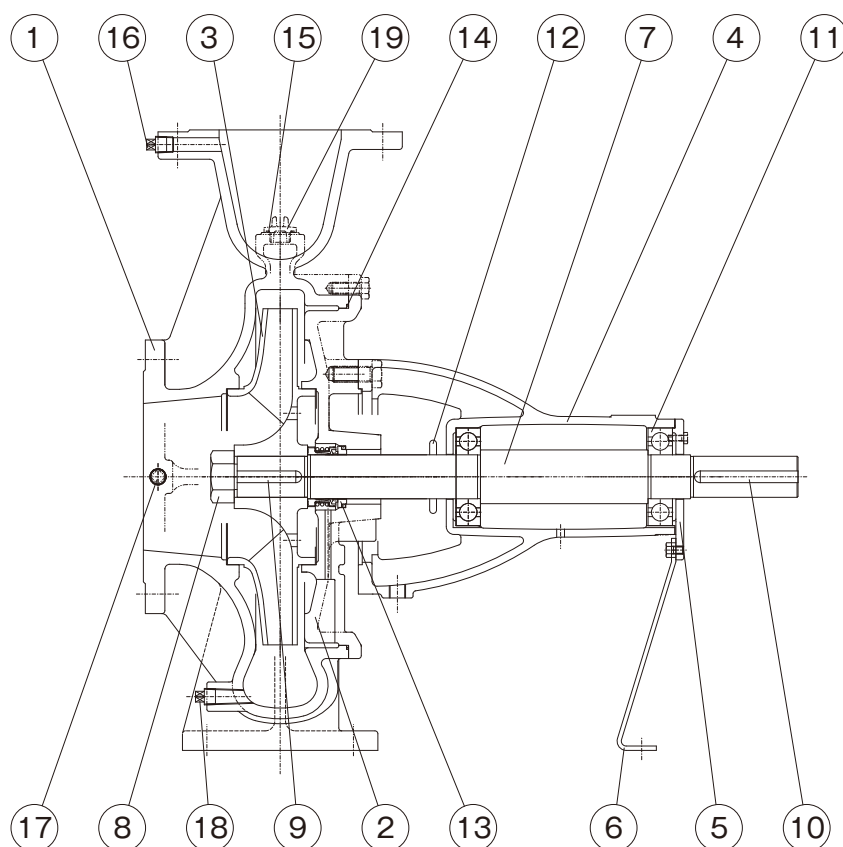

■Parts list

No.	Part name	Qty	Material
1	Casing	1	SCS13
2	Casing cover	1	SCS13
3	Impeller	1	SCS13
4	Bearing case	1	FC200
5	Bearing cover	1	FC200
6	Mounting leg	1	SS400
7	Shaft	1	SUS304
8	Impeller nut	1	SUS304
9	Impeller key	1	SUS304
10	Coupling key	1	S45C
11	Ball bearing	2	SUJ2
12	Deflector	1	CR
13	Mechanical seal	1	SiC vs Carbon
14	O-ring	1	NBR
15	O-ring	1	NBR
16	Plug	1	SUS304
17	Plug	1	SUS304
18	Drain plug	1	SUS304
19	Priming plug	1	SCS13

※ The drawing shows the standard specifications. Contact us for special specifications because some parts may differ.

MEMO

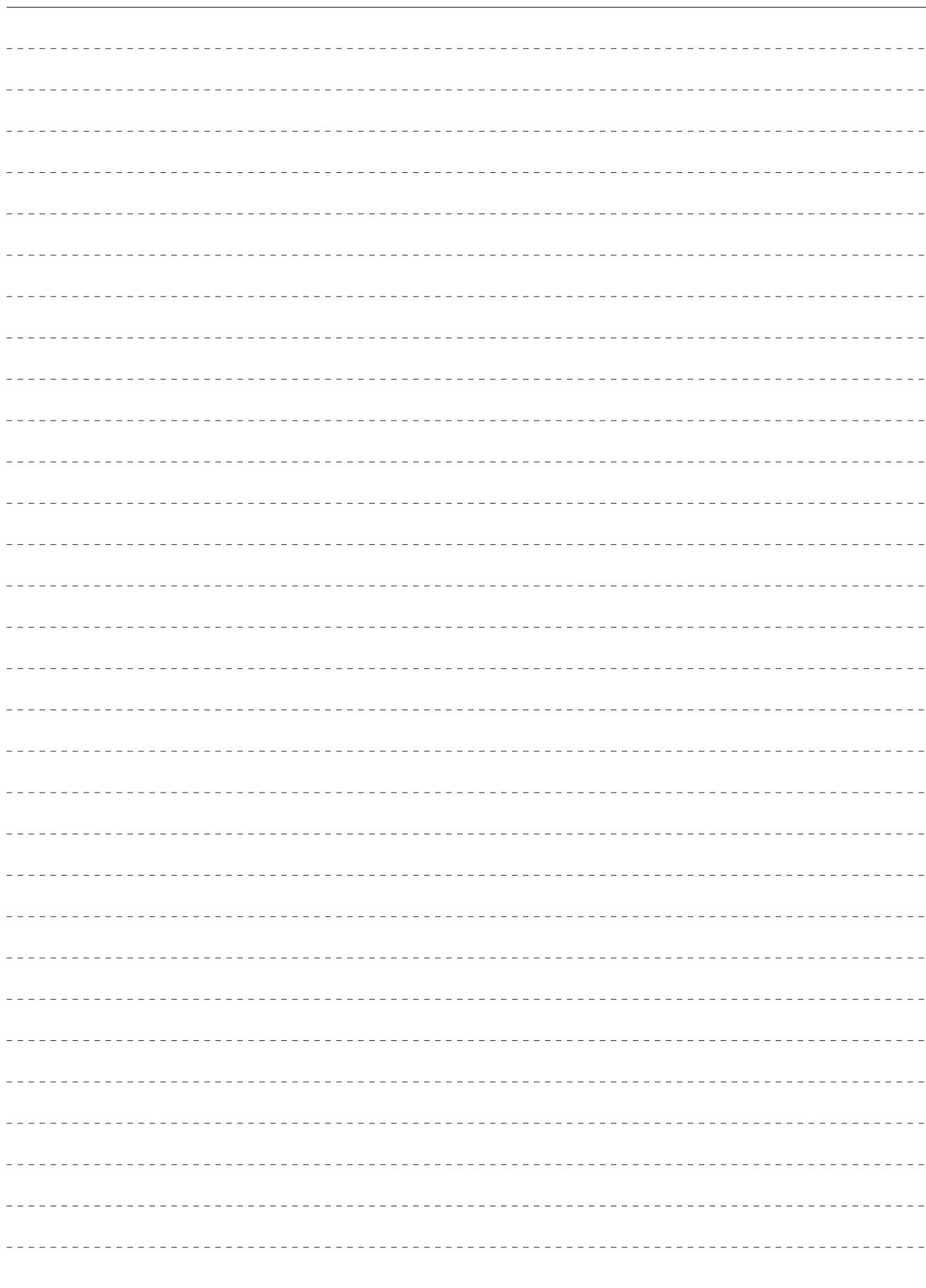



TERAL INC.

Head Office 230, Moriwake, Miyuki-cyo, Fukuyama-city, Hiroshima, 720-0003, Japan
Tel.+81-84-955-1111 Fax.+81-84-955-5777
www.teral.net

Teral Asia Limited

Room 1001,10/F, Olympia Plaza, 255 King's Road, North Point, Hong Kong
Tel.+852-2571-0935 Fax.+852-2571-0619

TERAL THAI CO.,LTD.

150 Moo 16 Udomsornayuth Rd., T.Bangkrasan, A.Bangpa-In, Ayutthaya 13160 Thailand
Tel.+66-3535-2148-9 Fax.+66-3535-2150

TERAL TRADING & SERVICE CO.,LTD.

150 Moo 16 Udomsornayuth Rd., T.Bangkrasan, A.Bangpa-In, Ayutthaya 13160 Thailand
Tel.+66-3535-2145-7 Fax.+66-3535-8549

Teral Malaysia Sdn.Bhd.

10, Jalan SS13/6A, Subang Jaya Industrial Estate, 47500, Subang Jaya, Selangor D.E, Malaysia
Tel.+60-3-5611 5775 Fax.+60-3-5612 5775

PT.Teral Indonesia Pumps and Fans

Komplek Pergudangan Taman Tekno Blok M No.26.Jl.BSD Sektor XI, Kelurahan Setu,
Kecamatan Setu, Kota Tangerang Selatan, Provinsi Banten.15314.
Tel.+62-21-29665778 Fax.+62-21-75673913

Teral Vietnam Limited Liability Company

9th Floor, LADECO Building, No. 266 Doi Can Street, Lieu Giai Ward, Ba Dinh District, Hanoi City, Vietnam
Tel.+84-24-393-52-790 Fax.+84-24-393-52-289

Teral General Machine (Shanghai) Co.,Ltd.

No.285, Yuan Qu Road(N), Bei Qiao, Min Hang District, Shanghai 201109, China
Tel.+86-21-6490-9128 Fax.+86-21-6490-9126

Teral-Aerotech Fans Private Ltd.

Plot No.188-189, Ecotech Extension-1, Surajpur Kasna Road, Greater Noida-201306, Uttar Pradesh, India
Tel.+91-9810162210, +91-9310162210

Teral Middle East F.Z.C.

1806-002, 18th floor, BB1, Mazaya Business Avenue, JLT, Dubai, UAE. PO Box 414781
Tel.+971-4369 9039

Teral Pumps & Fans North America Ltd.

Suite # 197, 800-15355 24 Ave Surrey, B.C., CANADA V4A 2H9
Tel.+1-604-839-1008

Teral Philippines Inc.

Roof Deck 3, Vernida 1 Building, 120 Amorsolo St., Legaspi Village, Makati City
Tel.+63 2 7717-9314